

**Reverse Stand-Off Voltage :  
58 to 430 V**

**Features**

- High current transient suppressors.
- Excellent Clamping Capability.
- Glass Passivated chip
- Bi-directional.
- Low Slope Resistance.
- Hazardous Substances Free.
- RoHS Compliant.
- High Temperature soldering: 260°C/10 seconds at terminals
- Epoxy Encapsulated.
- UL certified

**Axial Lead**



**Dimensions**

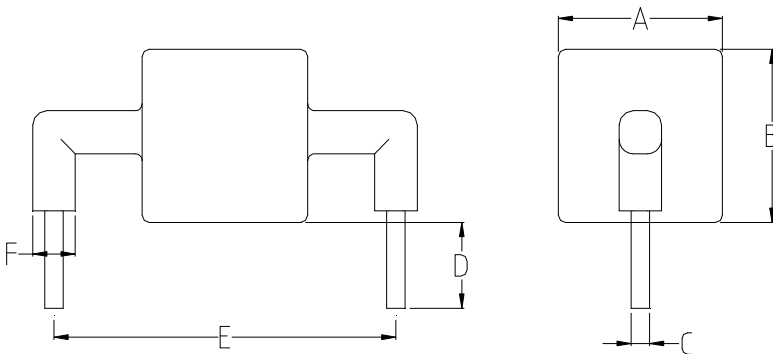

		UNIT
A	max 14.5	mm
B	max 12.7	mm
C	1.30±0.02	mm
D	6.0±1.0	mm
E	24.15±0.7	mm
F	max 4.0	mm

**Maximum Ratings (T<sub>A</sub>=25°C unless otherwise noted)**

Parameter	Symbol	Value		UNIT
Current Rating, Rated IPP measured with 8/20us pulse	I <sub>pp</sub>	K1	1	Kamps
		KA	3	
		KB	6	
		KC	10	
		KD	15	
Operating junction and storage temperature range	T <sub>J</sub> , T <sub>STG</sub>	-55 to +150		°C

Ratings and Characteristics Curves ( $T_A=25^{\circ}\text{C}$  unless otherwise noted)

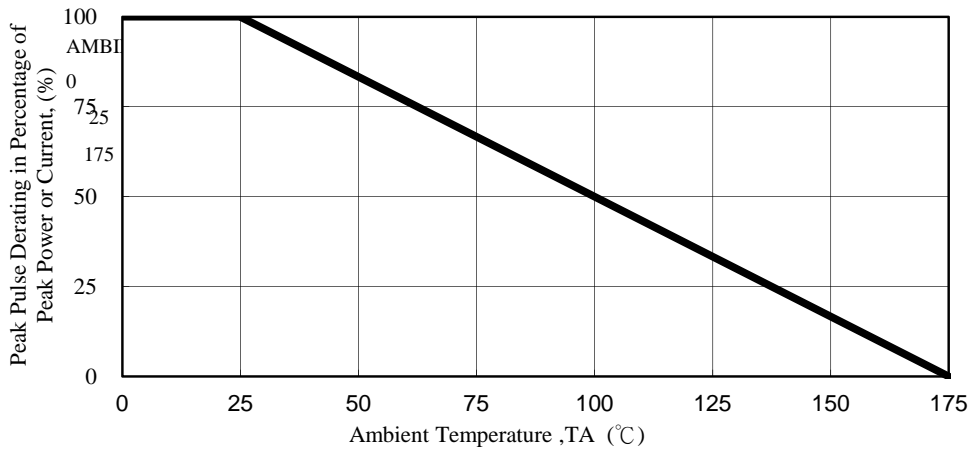

Fig. 1 - Pulse Derating Curve

Recommended Soldering Parameters

IR-Reflow Condition			
Pre Heat	Temp. min	150	$^{\circ}\text{C}$
	Temp. max	200	$^{\circ}\text{C}$
	Time(min to max)	60-180	sec
Ramp up rate (150-200 $^{\circ}\text{C}$ )		<3	$^{\circ}\text{C}/\text{sec}$

Reflow	Liquidus Temp.	>220	$^{\circ}\text{C}$
	Peak Temp.	255-260	$^{\circ}\text{C}$
	Time(Liq. to Peak)	60-150	sec
Ramp up rate (220-200 $^{\circ}\text{C}$ )		<3	$^{\circ}\text{C}/\text{sec}$
Time within actual peak temp.		10-30	sec

Ramp down Rate	<5	$^{\circ}\text{C}/\text{sec}$
Time(25 $^{\circ}\text{C}$ to Peak temp.)	<6	min
Do not exceed	280	$^{\circ}\text{C}$

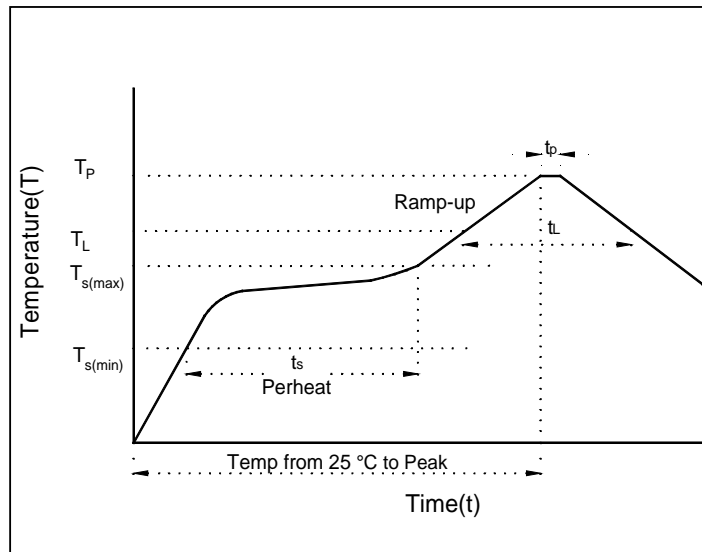

Electrical Characteristics( $T_A=25^{\circ}\text{C}$  unless otherwise noted)

Part Number	Reverse Stand-Off Voltage		Breakdown Voltage	Test Current	Current Rating	Maximum Clamping Voltage	Reverse Leakage
	VAC(V)	VDC(V)	VBR(V) MIN.@IT	IT(mA)	8/20 $\mu$ s (KA)	VC(V) @IPP	IR( $\mu$ A) @VDC
TK1076	54	76	83	10	1	135	20
TKA058	40	58	64	10	3	110	20
TKA076	54	76	85	10	3	140	20
TKA380	275	380	401	10	3	520	20
TKA430	310	430	440	10	3	625	20
TKB058	40	58	64	10	6	110	20
TKB066	45	66	70	10	6	125	20
TKB076	54	76	83	10	6	135	20
TKB170	130	170	180	10	6	260	20
TKB190	145	190	200	10	6	290	20
TKB240	180	240	250	10	6	340	20
TKB380	275	380	401	10	6	520	20
TKB430	310	430	440	10	6	625	20
TKC058	40	58	64	10	10	110	20
TKC066	45	66	70	10	10	125	20
TKC076	54	76	83	10	10	135	20
TKC170	130	170	180	10	10	260	20
TKC190	145	190	200	10	10	290	20
TKC240	180	240	250	10	10	340	20
TKC380	275	380	401	10	10	520	20
TKC430	310	430	440	10	10	625	20
TKD058	40	58	64	10	15	110	20
TKD076	54	76	85	10	15	145	20